

This file has been cleaned of potential threats.

To view the reconstructed contents, please SCROLL DOWN to next page.



प्लाज़्मा अनुसंधान संस्थान  
INSTITUTE FOR PLASMA RESEARCH  
परमाणु ऊर्जा विभाग, भारत सरकार का एक सहायता प्राप्त  
संस्थान  
An Aided Institute of Department of Atomic Energy,  
Government of India



इन्दिरा पुल के पास, भट, गांधीनगर - 382 428 भारत  
दूरभाष: (079) 2396 2020/2021/2028  
फैक्स: 91-079-23962277  
वेब: [www.ipr.res.in](http://www.ipr.res.in)

NEAR INDIRA BRIDGE, BHAT  
DIST. GANDHINAGAR - 382 428 (INDIA)  
Phone: (079) 2396 2020/2021/2028  
Fax : 91-079-23962277  
Web : [www.ipr.res.in](http://www.ipr.res.in)

## ENQUIRY

ENQUIRY NO : IPR/EQL/18-19/366  
Date : 16-01-2019

**Due on : 14-02-2019 by 1:00 PM IST**

Please send your offer in sealed envelope specifying Enquiry No, Date & Due Date, ALONG WITH your credentials for the following items:

### Important Note:

Please note that e-mail quotations are not acceptable however you may send your queries (if any) to [localpurchase@ipr.res.in](mailto:localpurchase@ipr.res.in)

Please ensure your sealed quotation reaches this office not later than above mentioned due date and time.

Kindly go through the following documents properly before quoting which are available on the IPR web portal i.e., [http://www.ipr.res.in/documents/tender\\_terms.html](http://www.ipr.res.in/documents/tender_terms.html) / attached herewith.

- 1) Instructions to the bidders & Terms and conditions (refer Form No: **IPR-LP-01.V4**)
- 2) Bidding format

**GST for Goods and Services (IGST/CGST/SGST TAX BENEFITS):** Please refer **clause no: 8** of Form No: **IPR-LP-01.V4**

## QUOTATION SHOULD BE ADDRESSED TO PURCHASE OFFICER ONLY

Sr No	Description	Quantity
1	Electrical workbench as per the detailed specifications attached	1.0 Nos.

Note: required for new textile lab constructed at FCIPT R & D Building  
TDS as per CGST Act: As per provisions of section No. 51 of the CGST Act 2017,  
TDS @2% (IGST 2% or CGST 1% and SGST 1%) will be deducted while making payment to the suppliers where total value of orders/contracts/work orders exceeds Rs. 2.5 lakhs, in the event of order in Indian Rupees.  
Necessary TDS Certificate will be issued to the supplier after TDS deduction

Encl: As per attachment.

Sd/-

Mr. D. Ramesh

**Information to Vendors:** We are working towards a single platform for our future requirement. Hence, please refer IPR website i.e, <http://www.ipr.res.in/documents/tendersenq.html> for our future requirement.

Sr. No.	IPR Specifications
1.	Table Size should be 2340 mm X 925 mm X 1815 mm (LXDXH) within ( $\pm 10\%$ )
2.	Table should be made of CRCA steel and Supported by horizontal ERW Tube of 40mm * 40mm * 16mm. Screws used for assembling of frames should be of Allen key type.
3.	Back wall of the table should be of 22G MS.
4.	All wooden shelves and top should be made of 30mm thick Particle board with formica decorative laminate with balancing Laminate of 0.6mm and PVC edge bidding of 2mm thickness.
5.	The table should be provided with horizontal drawer with frame support below and top (please refer the drawing).The drawer should be closed form backside.
6.	There should be provision of height adjustment up to approx. 25mm on each leg.
7.	The supplier has to provide MCBs, 15A/5A sockets and switches (must be anchor make) etc. in the switch board panels.
8.	The supplier has to provide minimum 4 numbers of 15/5A sockets and 12nos.of 5A sockets with switches in each panel.
9.	The supplier has to provide two small standard make tubelight with protective cover below the shelf such that the sufficient light should come on the top of the table.
10.	All the sheet component should be pre-treated in 7 tank pretreatment plant prior to painting. The process includes degreasing ,de-rusting , phosphating and drying to attain proper phosphate coat and crystallling the surface. The phosphated Product should be powder coated in melamine paint. (Blue Colour)
11.	After final painting all the components should be given heat Treatment (Oven baking) at standard temperature.

Please see Technical Drawings for further details, all dimensions can vary within ( $\pm 10\%$ )

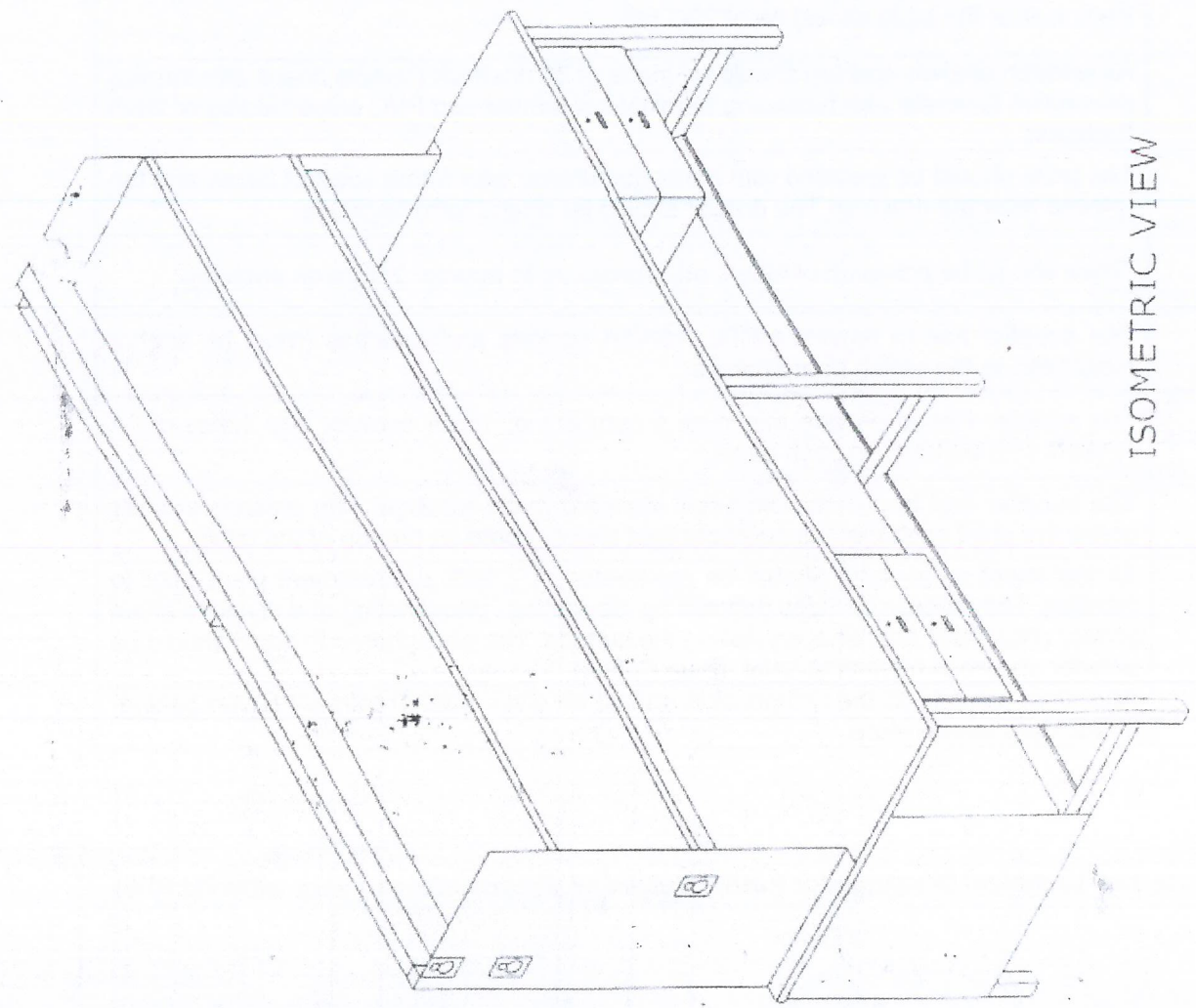

ISOMETRIC VIEW



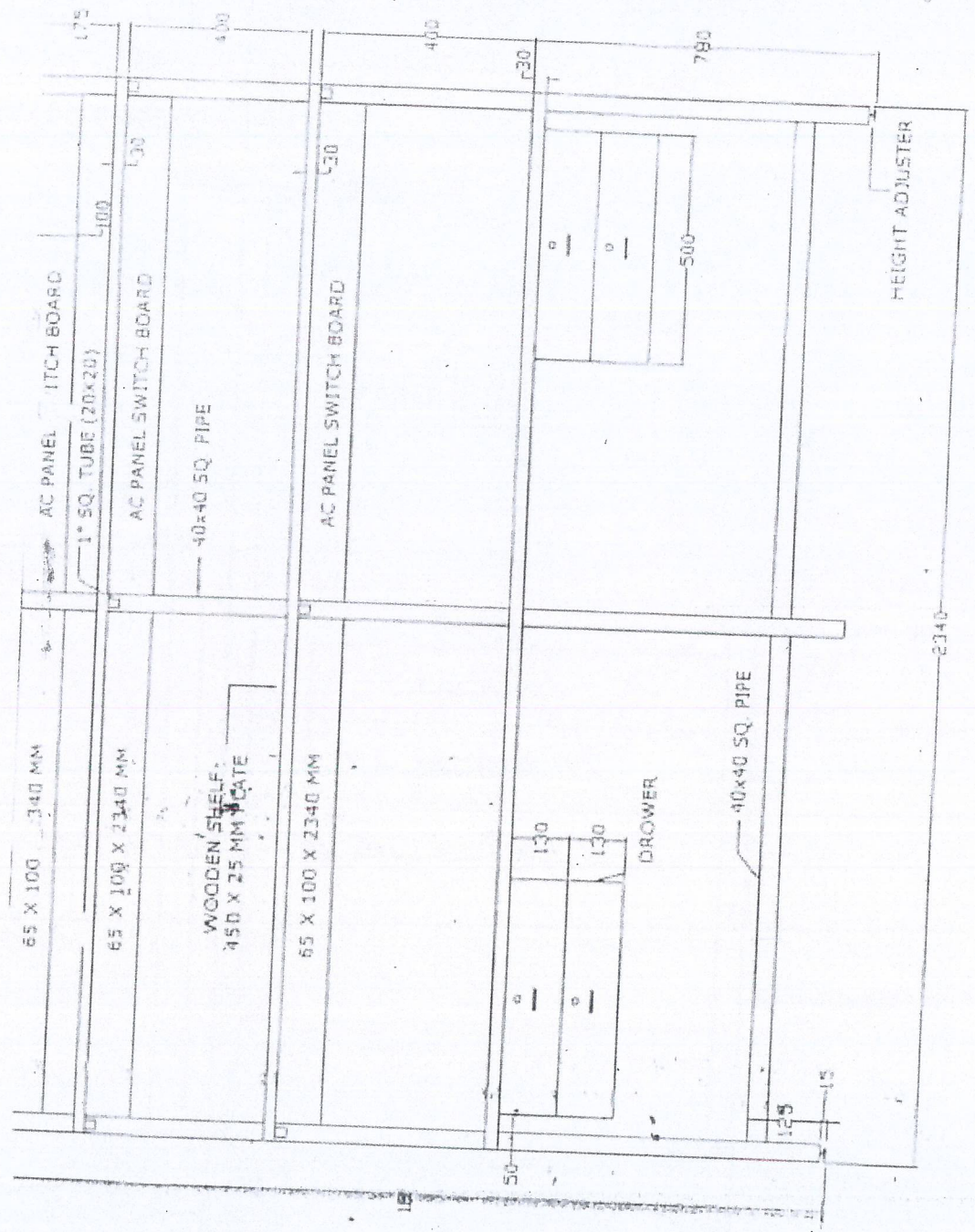

ALL DIMENSION ARE IN MM

Front View

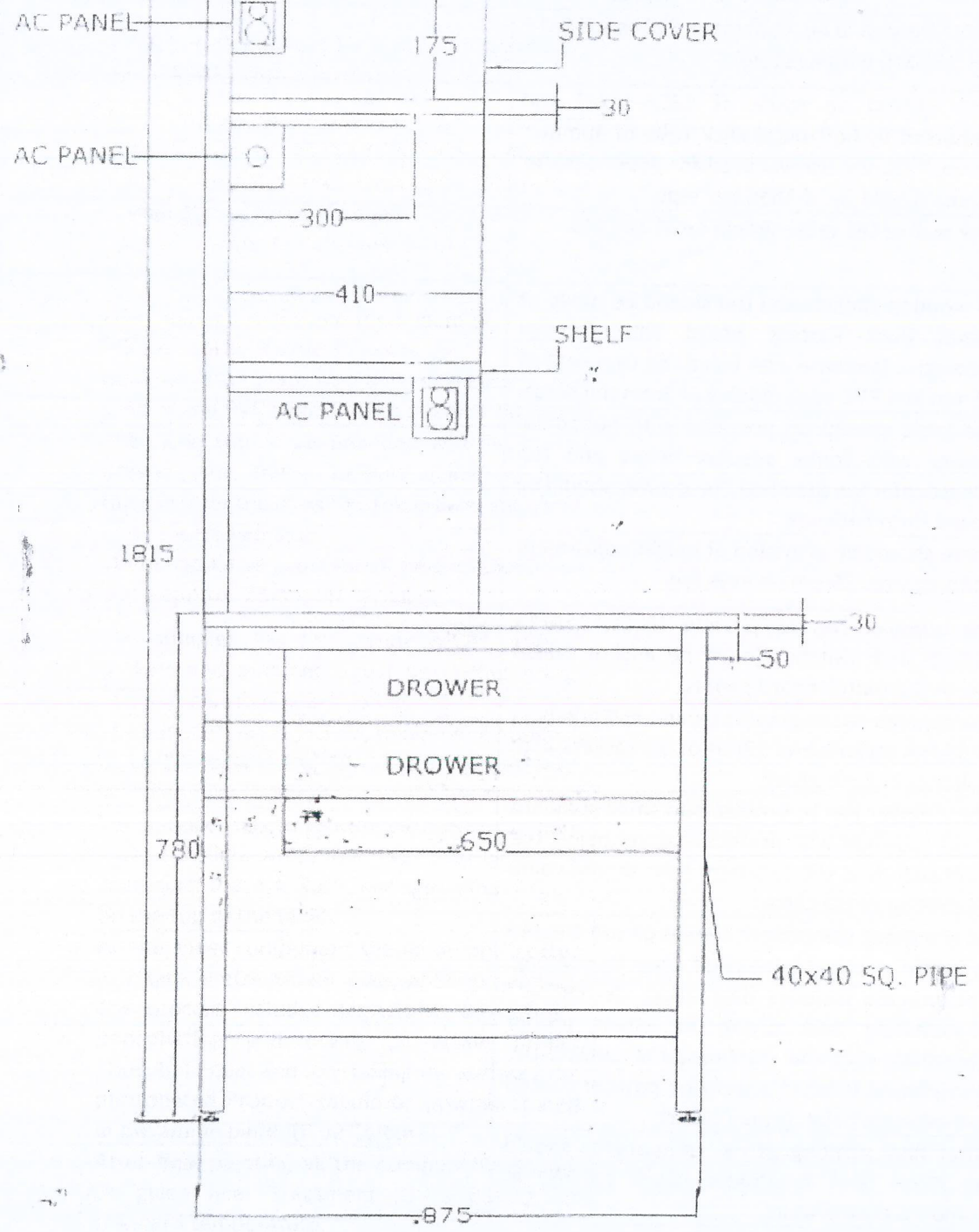

SIDE VIEW



Sr. No.	IPR Specifications	Vendor Compliance
1.	Table Size should be 2340 mm X 925 mm X 1815 mm (LXDXH) within ( $\pm 10\%$ )	
2.	Table should be made of CRCA steel and Supported by horizontal ERW Tube of 40mm * 40mm * 16mm. Screws used for assembling of frames should be of Allen key type.	
3.	Back wall of the table should be of 22G MS.	
4.	All wooden shelves and top should be made of 30mm thick Particle board with formica decorative laminate with balancing Laminate of 0.6mm and PVC edge bidding of 2mm thickness.	
5.	The table should be provided with horizontal drawer with frame support below and top (please refer the drawing).The drawer should be closed form backside.	
6.	There should be provision of height adjustment up to approx. 25mm on each leg.	
7.	The supplier has to provide MCBs, 15A/5A sockets and switches (must be anchor make) etc. in the switch board panels.	
8.	The supplier has to provide minimum 4 numbers of 15/5A sockets and 12nos.of 5A sockets with switches in each panel.	
9.	The supplier has to provide two small standard make tubelight with protective cover below the shelf such that the sufficient light should come on the top of the table.	
10.	All the sheet component should be pre-treated in 7 tank pretreatment plant prior to painting. The process includes degreasing, de-rusting , phosphating and drying to attain proper phosphate coat and crystallizing the surface. The phosphated Product should be powder coated in melamine paint. (Blue Colour)	
11.	After final painting all the components should be given heat Treatment (Oven baking) at standard temperature.	